

CADENAS DE RODILLOS SIMPLES

DIN 8187 – DIN 8188

Material: Acero, Niquelada, Acero inoxidable

Rfcia. JOCAR	Norma ISO	P x B Pulgadas	P x B mm.	D1	D2	F	G	Rotura Kg
NORMA EUROPEA DIN 8187								
110	--	3/8 x 5/32	9.525 x 3,94	6.35	3.31	12.8	8.1	1000
120	06B-1	3/8 x 7/32	9.525 x 5.72	6.35	3.31	14.8	8.1	1000
140	081	1/2 x 1/8	12,70 x 3,30	7.75	3.61	11.5	9.5	820
145	084	1/2 x 3/16	12,70 x 4,88	7.75	3.91	14.7	10.2	1600
190	08B-1	1/2 x 5/16	12,70 x 7.75	8.51	4.45	18.5	11.7	1900
195	----	5/8 x 1/4	15,87 x 6,48	10.16	5.08	19.0	14.2	2600
200	10B-1	5/8 x 3/8	15,87 x 9,65	10.16	5.08	21.4	14.2	2600
210	12B-1	3/4 x 7/16	19,05 x 11,68	12.07	5.72	24.5	16.4	3200
220	16B-1	1 x 0,67	25,4 x 17,02	15.87	8.27	36.2	21.0	6600
230	20B-1	1 1/4 x 3/4	31,75 x 19,56	19.05	10.15	44.9	25.0	9500
240	24B-1	1 1/2 x 1	38,1 x 25,4	25.40	14.55	60.0	34.5	16000
250	28B-1	1 3/4 x 1 1/4	44,45 x 30,99	27.94	15.85	71.4	37.0	20000
260	32B-1	2 x 1 1/4	50,8 x 30,99	29.21	17.75	71.4	42.0	25000

NORMA AMERICANA DIN 8188								
410	25	1/4 x 1/8	6.35 x 3,18	3.33	2.31	8.1	5.8	420
420	35	3/8 x 3/16	9,525 x 4,77	5.08	3.59	12.7	8.8	1000
440	40	1/2 x 5/16	12,7 x 7,94	7.94	3.97	18.35	11.7	1800
450	50	5/8 x 3/8	15,875 x 9,53	10.16	5.09	21.9	14.2	2700
460	60	3/4 x 1/2	19,05 x 12,7	11.9	5.95	26.8	16.4	3600
480	80	1 x 5/8	25,4 x 15,88	15.87	7.93	35	21.0	6600
500	100	1 1/4 x 3/4	31,75 x 19,05	19.05	9.53	41.1	30.18	10800
520	120	1 1/2 x 1	38,10 x 25,4	22.23	11.10	50.8	36.20	15400
540	140	1 3/4 x 1	44,45 x 25,4	25.40	12.70	54.9	42.24	20800
560	160	2 x 1 1/4	50,80 x 31,75	28.58	14.27	65.5	48.26	26200
600	200	2 1/2 x 1 1/2	63,50 x 38,10	39.68	19.84	80.3	60.33	43000

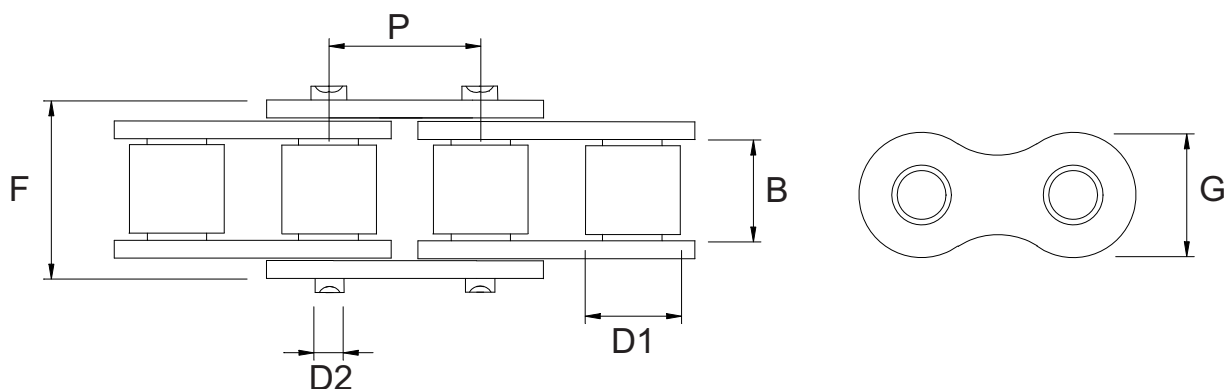

CADENAS DE RODILLOS DOBLES

DIN 8187 – DIN 8188

Material: Acero, Niquelada, Acero inoxidable

Rfcia JOCAR	Norma ISO	P x B Pulgadas	P x B mm	D1	D2	F	H	G	Rotura Kg
----------------	--------------	-------------------	-------------	----	----	---	---	---	--------------

NORMA EUROPEA DIN 8187

2120	06B-2	3/8 x 7/32	9,525 x 5,72	6.35	3.31	25.04	10.24	8.10	1900
2190	08B-2	1/2 x 5/16	12,7 x 7,75	8.51	4.45	32.42	13.92	11.70	3800
2200	10B-2	5/8 x 3/8	15,875 x 9,65	10.16	5.08	37.69	16.59	14.20	5100
2210	12B-2	3/4 x 7/16	19,05 x 11,68	12.07	5.72	43.96	19.6	16.40	6100
2220	16B-2	1 x 0,67	25,4 x 17,02	15.87	8.27	74.38	31.88	21.0	11500
2230	20B-2	1 1/4 x 3/4	31,75 x 19,56	19.05	10.17	81.47	36.45	25.0	17000
2240	24B-2	1 1/2 x 1	38,1 x 25,40	25.40	14.63	108.4	48.36	34.5	28500
2250	28B-2	1 3/4 x 1 1/4	44,45 x 30,99	27.94	15.90	130.9	59.56	37.0	36000
2260	32B-2	2 x 1 1/4	50,8 x 30,99	29.21	17.81	130.4	58.55	42.0	45000

NORMA AMERICANA DIN 8188

2420	35-2	3/8 x 3/16	9,525 x 4,77	5.08	3.59	22.83	10.13	8.8	2800
2421	--	3/8 x 3/16	9,525 x 4,77	5.08	3.59	24.73	10.13	8.8	2000
2440	40-2	1/2 x 5/16	12,7 x 7,94	7.94	3.97	32.73	14.38	12.07	3200
2450	50-2	5/8 x 3/8	15,875 x 9,65	10.16	5.09	39.74	18.11	15.09	5200
2460	60-2	3/4 x 1/2	19,05 x 12,7	11.9	5.95	49.88	22.78	18.08	8000
2480	80-2	1 x 5/8	25,4 x 15,88	15.87	7.93	64.29	29.29	24.13	11700
2500	100-2	1 1/4 x 3/4	31,75 x 19,05	19.05	9.53	77.0	35.76	30.18	21600
2520	120-2	1 1/2 x 1	38,10 x 25,40	22.23	11.10	96.3	45.44	36.20	30800
2540	140-2	1 3/4 x 1	44,45 x 25,40	25.40	12.70	103	48.87	42.24	41600
2560	160-2	2 x 1 1/4	50,80 x 31,75	28.58	14.27	124	58.55	48.26	52400
2600	200-2	2 1/2 x 1 1/2	63,50 x 38,10	39.68	19.84	151	71.55	60.33	86000

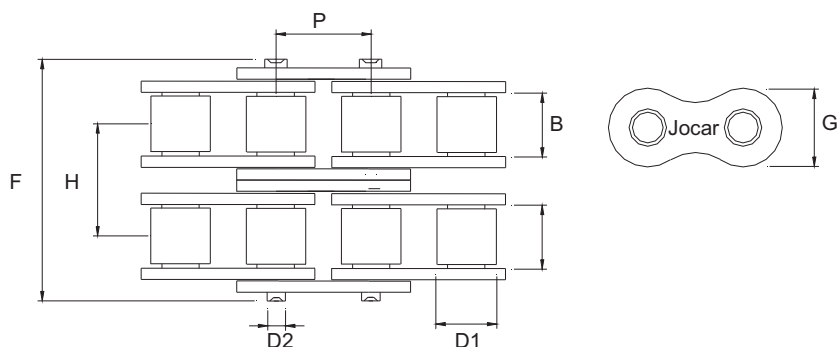

CADENAS DE RODILLOS TRIPLES

DIN 8187 – DIN 8188

Material: Acero, Niquelada, Acero inoxidable

Rfcia. JOCAR	Norma ISO	P x B Pulgadas	P x B mm	D1	D2	F	H	G	Rotura Kg
-----------------	--------------	-------------------	-------------	----	----	---	---	---	--------------

NORMA EUROPEA DIN 8187

3120	06B-3	3/8 x 7/32	9,525 x 5,72	6.65	3.31	35.28	10.24	8.1	2800
3190	08B-3	1/2 x 5/16	12,7 x 7,75	8.51	4.45	46.34	13.92	11.70	5500
3200	10B-3	5/8 x 3/8	15,875 x 9,65	10.16	5.08	54.28	16.59	14.20	7600
3210	12B-3	3/4 x 7/16	19,05 x 11,68	12.07	5.72	63.42	19.46	16.40	9200
3220	16B-3	1 x 0.67	25,4 x 17,02	15.87	8.27	106.2	31.88	21.0	18500
3230	20B-3	1 1/4 x 3/4	31,75 x 19,56	19.05	10.17	118	36.45	25.0	25000
3240	24B-3	1 1/2 x 1	38,10 x 25,4	25.40	14.63	156.82	48.36	34.5	42500
3250	28B-3	1 3/4 x 1 1/4	44,45 x 30,99	27.9	15.9	190.56	59.56	37.0	53000
3260	32B-3	2 x 1 1/4	50,8 x 30,99	29.2	17.81	188.49	58.55	42.0	67000

NORMA AMERICANA DIN 8188

3420	35-3	3/8 x 3/16	9,525 x 4,77	5.08	3.59	32.96	10.13	8.8	2800
3440	40-3	1/2 x 5/16	12,7 x 7,94	7.94	3.97	47.11	14.38	12.07	4800
3450	50-3	5/8 x 3/8	15,875 x 9,65	10.16	5.09	58.12	18.11	15.09	7800
3460	60-3	3/4 x 1/2	19,05 x 12,7	11.9	5.95	72.66	22.78	18.08	12500
3480	80-3	1 x 5/8	25,4 x 15,88	15.87	7.93	93.58	29.29	24.13	18000
3500	100-3	1 1/4 x 3/4	31,75 x 19,05	19.05	9.53	113.0	35.76	30.18	32400
3520	120-3	1 1/2 x 1	38,10 x 25,40	22.23	11.10	141.0	45.44	36.20	46200
3540	140-3	1 3/4 x 1	44,45 x 25,40	25.40	12.70	152.0	48.87	42.24	62400
3560	160-3	2 x 1 1/4	50,80 x 31,75	28.58	14.27	182.0	58.55	48.26	78600
3600	200-3	2 1/2 x 1 1/2	63,50 x 38,10	39.68	19.84	223.0	71.55	60.33	129000

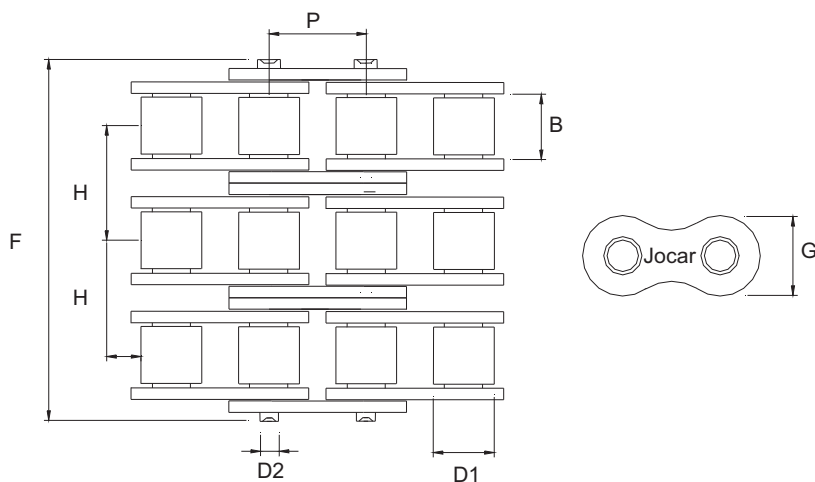

Cadena de rodillos Serie GL

Material: Acero, Niquelada, Acero inoxidable

Paso: P mm pulgadas	b ₁ min.	b ₂ máx.	d ₁ máx.	d ₂	g	k máx.	l máx.	f cm ²	Carga rotura Kgs
9,53 3/8"	5,72	8,53	6,35	3,28	8,2	3,3	13,5	0,28	1.062
12,7 1/2"	7,75	11,3	8,51	4,45	11,5	3,9	17	0,5	1.930
15,88 5/8"	9,65	13,28	10,16	5,08	14,2	4,1	19,6	0,67	2.665
19,05 3/4"	11,68	15,62	12,07	5,72	15,5	4,6	22,7	0,89	3.360
25,4 1"	17,02	25,4	15,88	8,28	21	5,4	36,1	2,1	7.790

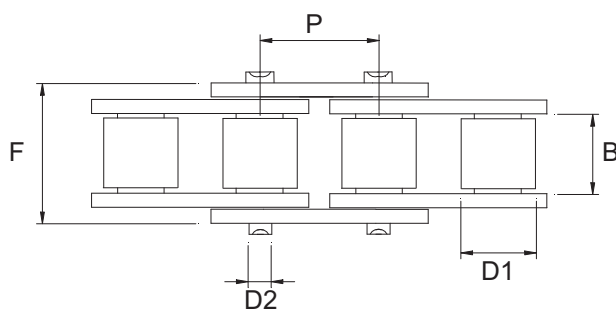
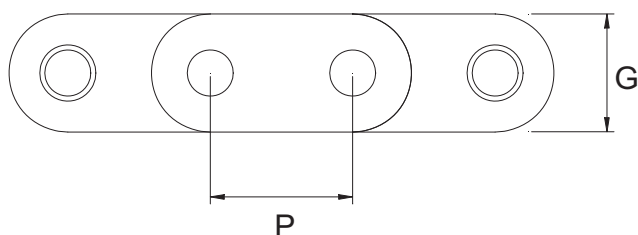

Cadena de ejes huecos - Eslabones acodados

Material: Acero, Niquelada.

CADENAS DE EJES HUECOS -DIN 81817-

RFCIA JOCAR	ISO	Paso	Rodillo	Eje hueco	Ancho	Rotura
		P	C	D	E	daN
190 H	08-B	12,7	8,51	4,5	16,6	1350
200 H	10-B	15,875	10,16	5	20,4	1450
210 H	12-B	19,05	12,07	5,75	24,8	1850
220 H	16-B	25,4	15,88	8,3	32,6	4500

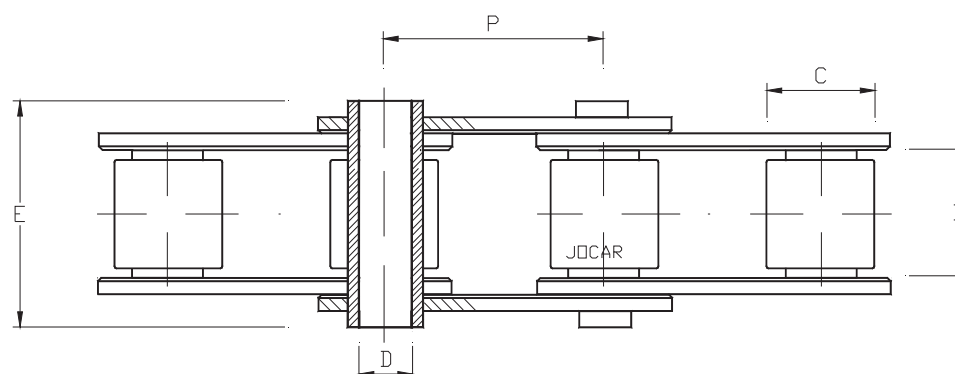

CADENAS DE ESLABONES ACODADOS

ISO	Paso P	Ancho B	Rodillo C	Eje D	Ancho E	Rotura
2.010	63,5	37,3	31,75	15,88	105	32000
2.512	77,9	39,1	41,28	19,05	118	47000
2.510	78,1	38,1	31,75	15,88	107	34000
2.814	88,9	37,5	44,45	22,22	139	64000
3.214	103,2	49,23	44,45	22,22	151	68000
3.315	103,45	48,2	45,24	23,85	157	74000
3.618	114,3	51,4	57,15	27,97	164	100000
4.020	127	69,85	63,5	31,75	215	126000
4.824	152,4	76,2	76,2	38,1	218	186000

