

Podemos entregar cualquier tipo de cadena con accesorios estándar ó especiales en un plazo de entrega mínimo. Disponemos en stock de las cadenas más habituales con aletas estándar.

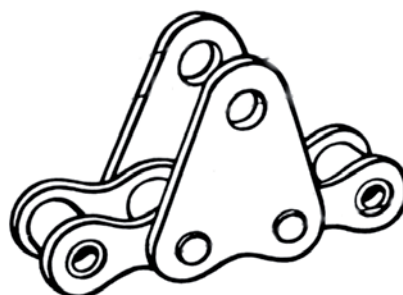
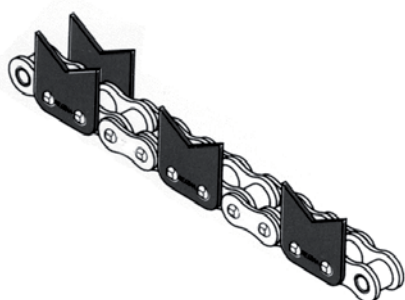
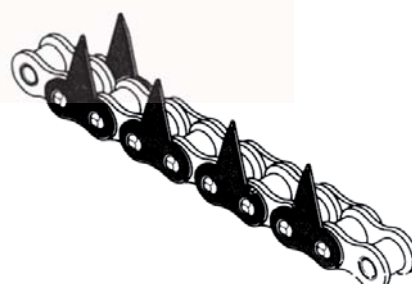
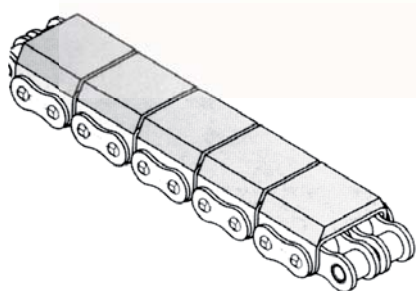

Cadenas con aletas

Material: Acero, Acero inoxidable

ISO	Paso P	A	C	D	E	F	K	L	M	N	S	V	h1	h2	h3	h4
06-B	9.52	8	17.75	3.5	1.15	3.21	9.0	4.0	19.0	27.0	10.6	5.0	9.5	13.5	17.6	6.5
08-B	12.70	11	24.2	4.3	1.55	4.37	13.5	5.5	27.6	38.4	14.5	8.0	14.1	19.5	25.25	8.75
10-B	15.87	14	29.9	5.3	1.6	4.99	16.0	7.0	31.6	45.6	17.5	9.0	16.2	23.2	30.2	10.5
12-B	19.05	18	35.25	6.4	1.8	5.63	19.5	9.75	35.5	54.9	19.7	9.75	18.2	28.1	36.2	11.6
16-B	25.40	24	46.0	8.2	3.0	8.19	25.90	12.0	53.8	77.7	26.7	13.9	25.40	37.35	47.6	16.3
20-B	31.75	35	58.1	9.0	3.5	10.08	35.50	15.2	63.5	100.5	33.0	17.02	30.50	45.7	58.9	19.8

Aleta vertical / 1 lado / 2 lados / 1 taladro / 2 taladros

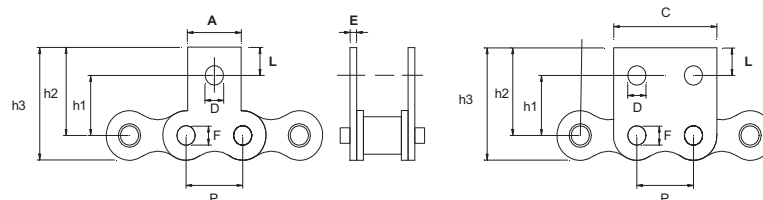

Aleta horizontal / 1 lado / 2 lados / 1 taladro / 2 taladros

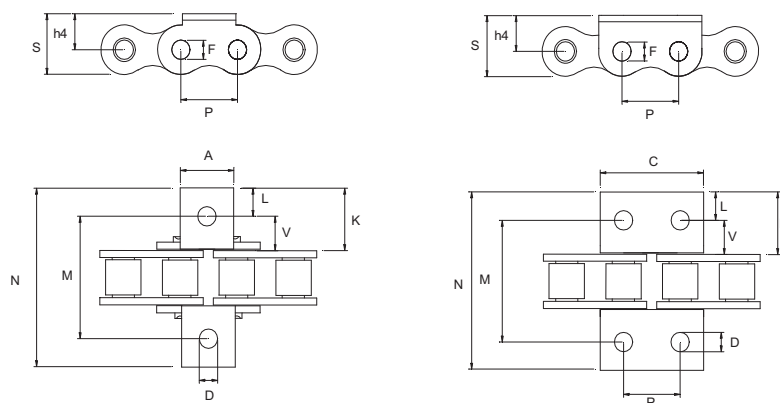

CADENA CON TACOS DE GOMA

Cadenas con placas en "U" y tacos de goma en la parte superior
 Las placas en "U" van sobre todos los eslabones exteriores
 Tacos de caucho en elastómero blanco resistente a la abrasión
 Temperatura máx. de utilización: 80 ° Dureza: 70° Shore A

ISO	P	b1	d1	d2	a	L	B	l	h1	H	Carga rotura
08B1-G	12.70	7.75	8.51	4.45	20.00	24.00	14.50	12.00	8.30	12.30	1.800
10B1-G	15.88	9.65	10.16	5.08	22.50	30.00	17.00	14.00	11.30	17.00	2.250
12B1-G	19.05	11.68	12.07	5.72	26.00	37.00	19.50	14.00	13.00	21.00	2.900
16B1-G	25.40	17.02	15.88	8.28	40.00	49.00	29.00	25.00	15.40	23.40	5.900
08B2-G	12.70	7.75	8.51	4.45	37.00	24.00	28.50	24.00	8.30	12.30	3.200
10B2-G	15.88	9.65	10.16	5.08	38.50	30.00	33.50	30.00	11.30	17.00	4.450
12B2-G	19.05	11.68	12.07	5.72	46.00	37.00	39.10	37.00	12.00	16.00	5.900

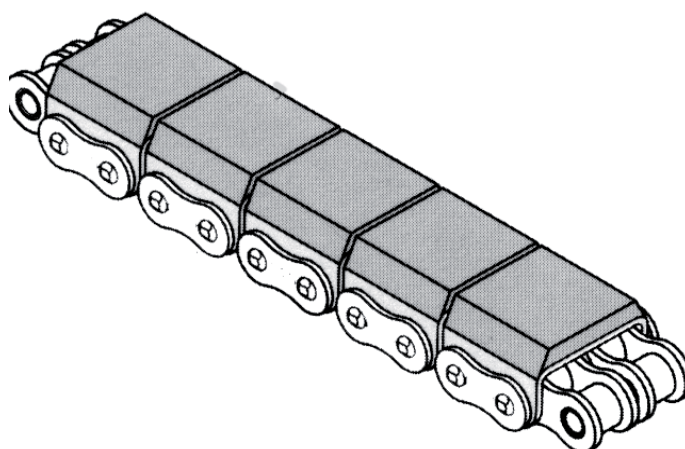
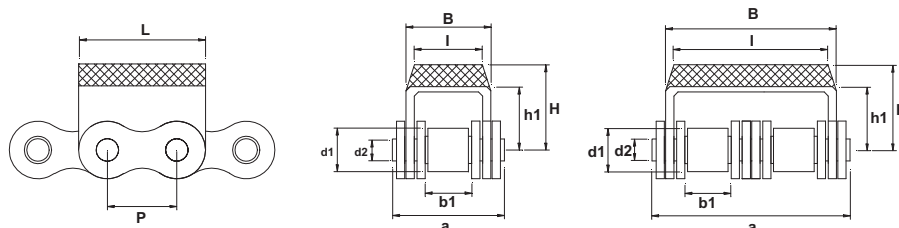

CADENA CON PIVOTES

Material: Acero, Acero inoxidable

ISO	PASO P	B	D	EJE CORTO		EJE NORMAL		EJE LARGO	
				E	F	E	F	E	F
06-B	9.525	5.72	3.28	9.52	14.8	11.3	16.4	21.5	26.6
08-B	12.70	7.75	4.45	9.52	16.8	15.5	22.5	29.5	36.5
084	12.70	4.88	4.09	9.52	15	15	20.5	25	30.4
10-B	15.875	9.65	5.08	11.91	20.2	17.8	26.2	34.4	42.8
12-B	19.05	11.68	5.72	14.30	24.0	20.7	30.4	40.2	50
16-B	25.4	17.02	8.28	19.05	35.0	33.2	49.2	65	81

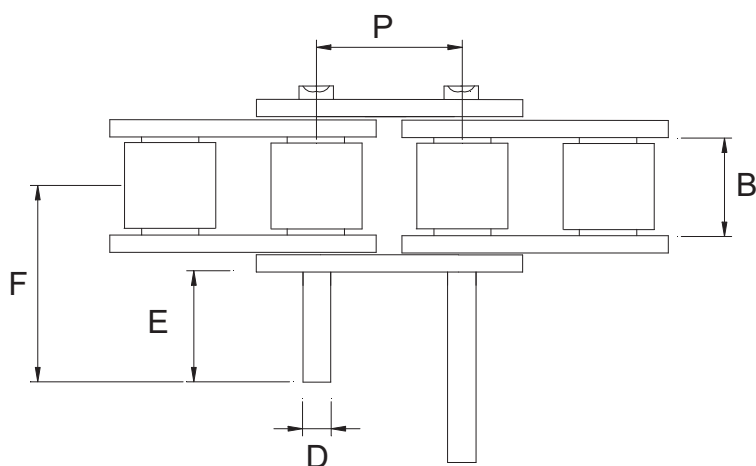

CADENA DE MALLAS JUNTAS FLEYER

Rfcia	Paso	S (esp)	d2	ANCHO MAXIMO "F" según combinación							
SERIE EUROPEA "LL"				2 x 2			4 x 4		6 x 6	8 x 8	
LL-08..	12,7	1.5	4,45	8.1			13		18.9		
LL-10..	15,87	1.6	5,08	9.3			16.4		22.8	29.1	
LL-12..	19,05	1.8-2,2	5,72	10.2			17.8		25.5		
LL-16..	25,4	3.2	8,28	16.6			29.6		42.4		
LL-20..	31,75	3,7	10,19	19.1			34.1		48.9	64.0	
LL-24..	38,1	5.2	14,63	25.8			46.8		67.5	88.1	
LL-28..	44,45	6.5	15,9	31.7			58.0		84.2	110.3	
LL-32..	50,8	6.2	17,81	30.7			55.6		80.5	105.2	
LL-40..	63,50	8.2	22,91	39.8			72.8		105.6	138.4	
LL-48..	76,20	10.2	29,26	48.7			89.7		130.5		
SERIE AMERICANA BL "LH"				2 x 2	2 x 3	3 x 4	4 x 4	4 x 6	6 x 6	8 x 8	
BL4- LH-08..	12,7	2.05	5.12	10.90	12.90	17.10	19.40	23.40	27.80	36.25	
BL5 -LH-10..	15,87	2.40	5.98	12.60	15.10	20.00	21.50	27.40	32.20	42.25	
BL6- LH-12..	19,05	3.30	7.97	17.20	20.50	27.10	30.50	37.25	44.00	57.25	
BL8- LH-16..	25,4	4.02	9.58	20.40	24.60	32.70	36.75	45.00	52.80	69.00	
BL10 LH-20..	31,75	4.90	11.16	24.40	29.40	39.20	44.25	54.00	63.80	83.50	
BL12 LH-24..	38,1	5.80	12.76	28.40	34.30	45.90	51.80	63.40	75.10	98.30	
BL14 LH-28..	44,45	6.55	14.33	32.00	38.70	51.80	58.50	71.50	84.60	111.0	
BL16 LH-32..	50,8	7.50	17.52	36.20	43.80	58.80	66.50	81.30	96.50	126.5	
SERIE AMERICANA "AL"				2 x 2			4 x 4		6 x 6		
AL-04..	12,7	1.55	4.01	8.2			14.6		21.0		
AL-05..	15,87	2.05	5.13	10.7			19.1		27.4		
AL-06..	19,05	2.4	5.99	12.3			22.3		32.4		
AL-08..	25,4	3.3	7.96	17.0			30.6		43.8		
AL-10..	31,75	4.1	9.56	20.8			37.4		54.0		
AL-12..	38,1	4.9	11.14	24.4			44.2		64.0		
AL-14..	44,45	5.8	12.74	28.5			51.9		75.1		
AL-16..	50,8	6.5	14.31	31.9			58.4		84.7		

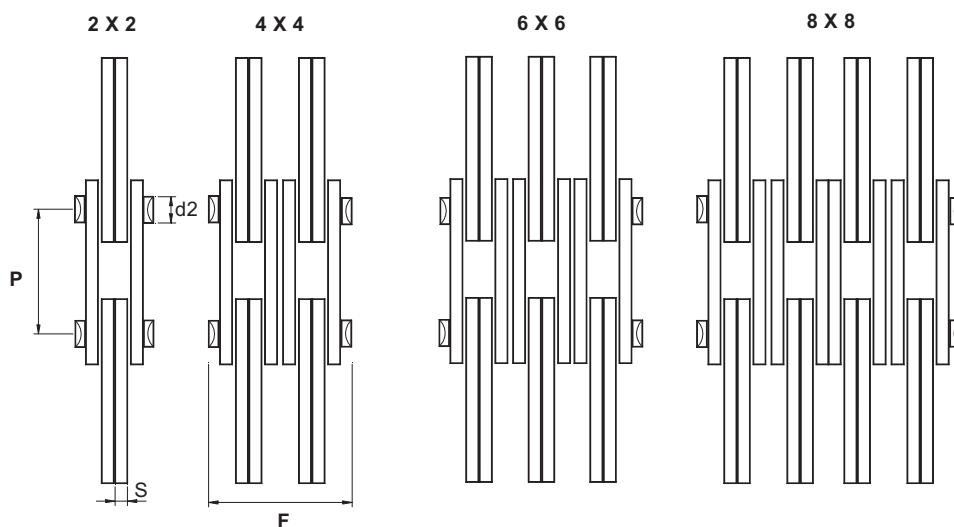

RFCIA	Pasos normalizados P	B	C	D1	D2	D3	e	G	S	D	E	Rotura
M- 20	40-50-63-80-100-125	16	9	12,5	25	30	3	18	2,5	6	31	2.000
M- 28	50-63-80-100-125-160	18	10	15	30	36	3,5	20	3	7	35	2.800
M- 40	63-80-100-125-160-200	20	12,5	18	36	42	4	25	3,5	8,25	41	4.000
M- 56	63-80-100-125-160-200	24	15	21	42	50	4,5	30	4	10	46	5.600
M- 80	80-100-125-160-200-250	28	18	25	50	60	5	35	5	12	55	8.000
M-112	80-100-125-160-200-250	32	21	30	60	70	6	40	6	15	64	11.200
M-160	100-125-160-200-250-315	37	25	36	70	88	7,5	50	7	18	74	16.000
M-224	125-160-200-250-315-400	43	30	42	85	102	9	60	8	21	85	22.400
M-315	160-200-250-315-400-500	48	36	50	100	122	10	70	10	25	100	31.500
M-450	200-250-315-400-500-630	56	42	60	120	142	12	80	12	30	118	45.000
M-630	250-315-400-500-630-800	66	50	70	140	170	14	100	14	36	138	63.000
M-900	250-315-400-500-630-800	78	60	85	170	210	16	120	16	44	160	90.000

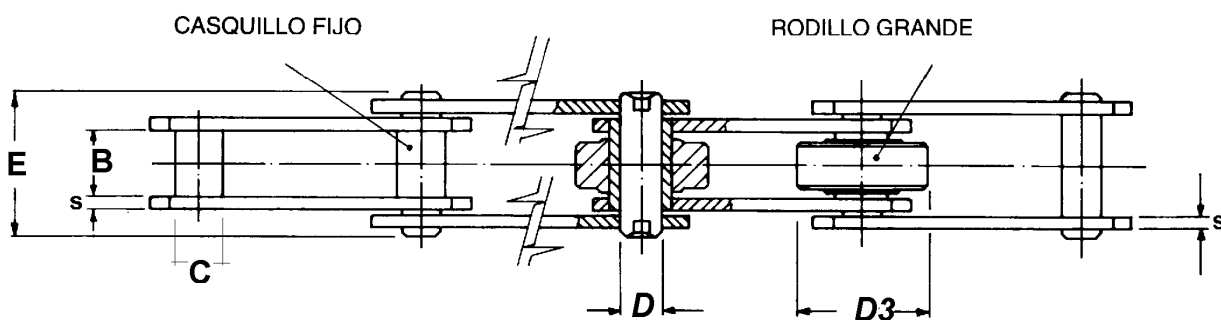
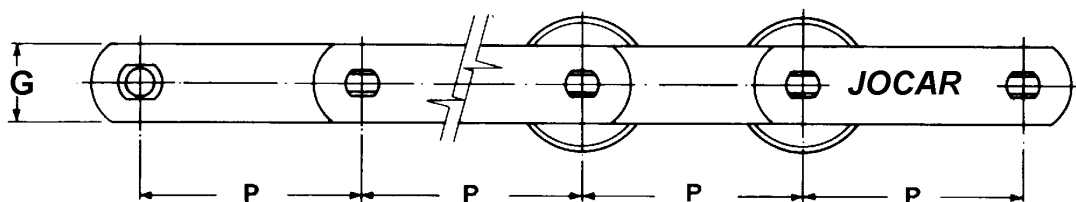

RODILLO
CON PESTAÑA

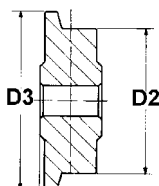

RODILLO PEQUEÑO

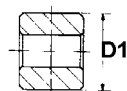

Cadena de transporte -DIN 8165-

RFCIA	P	B	D	C	D1	D2	D3	G	S	E	Rotura
2.104	40-63-80-100	17	10	15	20	32	40-48	25	3	37	4.000
2.106	40-63-80-100 125-160	21	12	18	26	40	50-60	30	4	46	6.000
2.109	40-63-80-100 125-160-200- 250	24	14	20	30	45	63-73	35	5	53	9.000
2.111	100-125-160- 200-250	29	16	22	32	55	72-87	40	6	63	11.000
2.114	100-125-160- 200-250-315	34	18	26	36	60	80-95	45	6	69	14.000
2.118	125-160-200- 250-315-400	44	20	30	42	70	100- 120	50	8	86	18.000
2.125	125-160-200- 250-315-400	54	25	36	50	80	125- 145	60	8	98	25.000
2.132	160-200-250- 315-400	64	30	42	60	90	140- 170	70	10	117	32.000
2.140	160-200-250- 315-400	68	32	44	60	100	150- 185	70	12	135	40.000
2.150	160-200-250- 315-400	75	36	50	70	110	160- 195	80	12	141	50.000
2.160	200-250-315- 400	88	42	56	80	120	170- 210	100	12	153	60.000

EJES MACIZOS

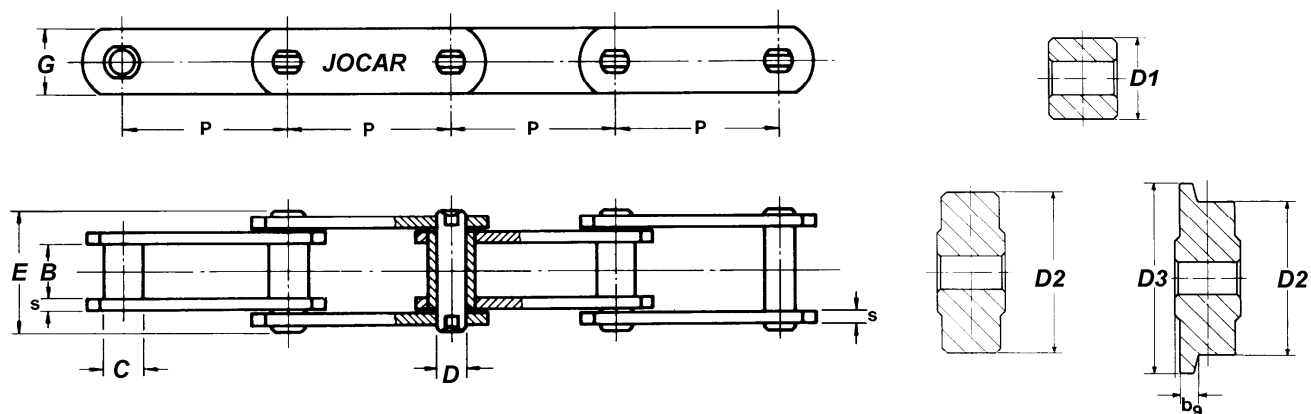

CADENA DE TABLILLAS-Termoplástica

TIPO RECTO

Referencia	Material	Paso	B	C	S
D800- 82,5	Acetal	38,1	82,5	42	4
D800-101,6		38,1	101,6	42	4
D800-114,3		38,1	114,3	42	4
D800-152,3		38,1	152,3	42	4
D800-190,5		38,1	190,5	42	4

LF800- 82,5	Acetal baja fricción	38,1	82,5	42	4
LF800-101,6		38,1	101,6	42	4
LF800-114,3		38,1	114,3	42	4
LF800-152,4		38,1	152,4	42	4
LF800-190,5		38,1	190,5	42	4

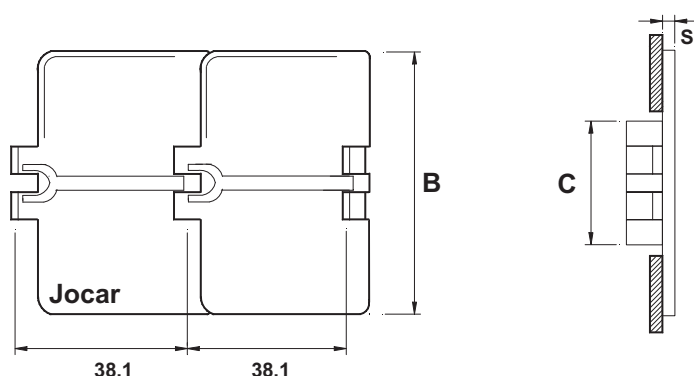

TIPO CURVO

Material platillos		Paso	B	C	R	s
Acetal	Acetal b. f.					
D 82,5	LF 82,5	38,1	82,5	42	500	4
D 114,3	LF 114,3	38,1	114,3	42	500	4
D 82,5 TAB	LF 82,5 TAB	38,1	82,5	42	500	4
D 114,3 TAB	LF 114,3 TAB	38,1	114,3	42	500	4

R= Radio mínimo de curva

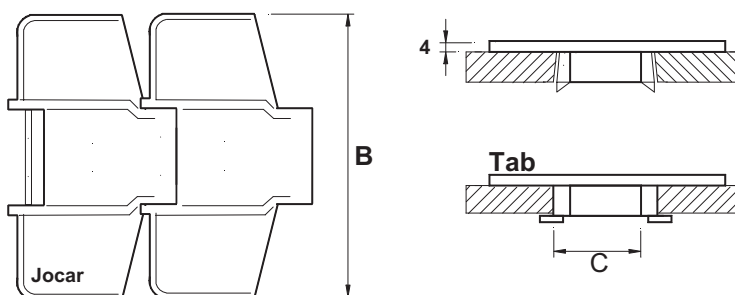

CADENA DE CHARNELAS en Acero Inoxidable

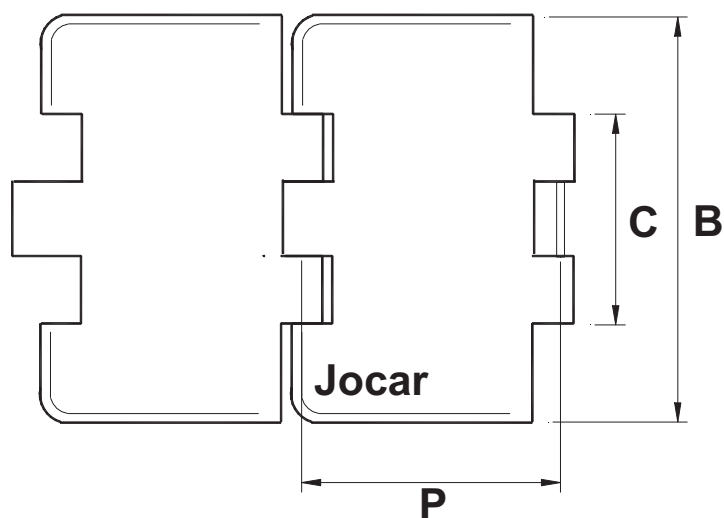

25.075	25,4	42	75
25.081	25,4	42	81
25.082	25,4	42	82,5
25.090	25,4	42	90
25.100	25,4	42	100

38.060	38,1	42	60
38.075	38,1	42	75
38.081	38,1	42	81
38.082	38,1	42	82,5
38.090	38,1	42	90
38.100	38,1	42	100
38.110	38,1	42	110
38.127	38,1	42	127
38.150	38,1	42	150
38.190	38,1	42	190,5

R U E D A S				Diám. P	
Dientes	E	A	AC	Paso 38,1	Paso 25,4
17	20	42	45	105,48	138,23
19	20	42	45	117,35	154,32
21	20	42	45	129,26	170,42
23	20	42	45	141,22	186,54
25	20	42	45	153,21	202,66
27	20	42	45	165,2	218,79

